

THIS DRAWING IS UNPUBLISHED. RELEASED FOR PUBLICATION .19
 © COPYRIGHT 19 BY AMP INCORPORATED. ALL INTERNATIONAL RIGHTS RESERVED.

LOC	DIST	P	F	REVISIONS				
G	14			ZONE	LTR	DESCRIPTION	DATE	APPD
					B	REV PER 0G3A-0001-03	07JAN03	JR TM

AMP WIRE RANGE	Listed	Certified
22-18 AWG STRANDED	22-18 AWG STRANDED	22-18 AWG STRANDED

METRIC
 DIMENSIONS LISTED IN mm [INCHES]

NOTES:

- 1. STAMP AMP 22-18* APPROX AS SHOWN
- 2. WIRE INSULATION DIA 4.32mm [.170] MAX
- 3. TONGUE MATERIAL THICKNESS 0.76±0.05mm [.030±.002]

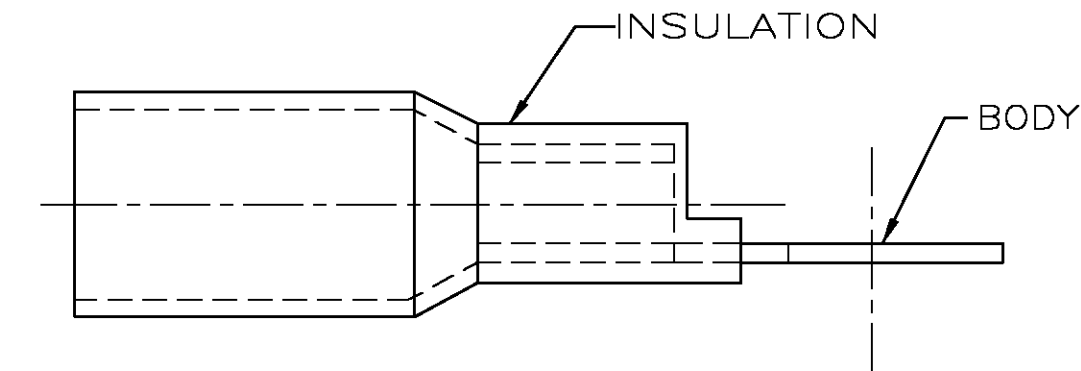
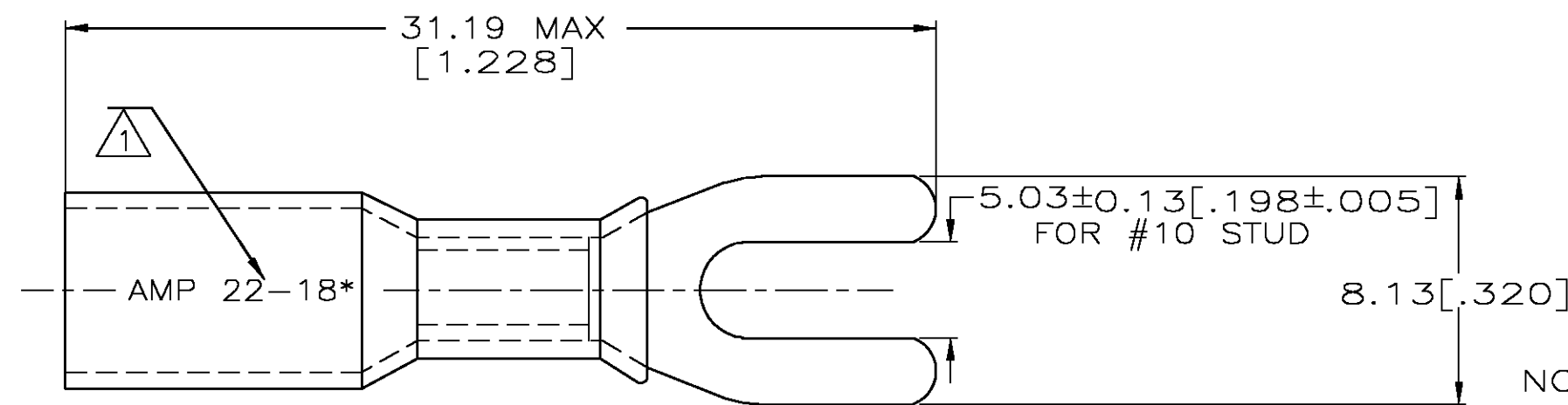

<p>AMP INCORPORATED CUSTOMER SERVICE SYSTEMS</p>		<p>MAX RECOMMENDED OPERATING TEMPERATURE: 125° C MAX</p>	<p>DO NOT SCALE PRINT. UNLESS SPECIFIED DIMENSIONS IN mm [INCHES] TOLERANCES ON: 2 PLC DEC ± 0.20[.008] 3 PLC DEC ± - ANGLES ± -</p>	<p>DR 6/93 S S GOULDEN CHK 6/93 R HERSEY APPD 6/93 B BARE APPD 6/93 M ELLIS PRODUCT SPEC - APPLICATION SPEC - WEIGHT -</p>	<p>50 1000 QTY</p>	<p>LOOSE PIECE LOOSE PIECE PACKAGE TYPE</p>	<p>8-55868-2 55868-1 PART NO</p>		
<p>FOR ADDITIONAL PRODUCT INFORMATION OR COPIES OF DRAWINGS AND TECHNICAL DOCUMENTS</p>	<p>PRODUCT INFORMATION CENTER 1-800-522-6752</p>	<p>VOLTAGE RATING: 600V MAX</p>	<p>MATERIAL BODY: ETP COPPER INSULATION: POLYOLEFIN COLOR: RED</p>	<p>AMP Incorporated Harrisburg, PA 17105-3608</p>	<p>NAME</p>	<p>TERMINAL, SPADE TONGUE, SEALABLE HEAT SHRINKABLE</p>	<p>SIZE B</p>	<p>CAGE CODE 00779</p>	<p>DRAWING NO C-55868</p>
<p>FOR APPLICATION TOOLING INFORMATION</p>	<p>TOOLING ASSISTANCE CENTER 1-800-722-1111</p>	<p>CIRCULAR MIL AREA: 0.26-0.96mm² [509-1900] STRANDED</p>	<p>FINISH EDP TIN PLATED</p>	<p>AMP</p>	<p>SCALE NTS</p>	<p>SHEET 1 OF 1</p>			
<p>FOR ORDER ENTRY</p>	<p>1-800-526-5142</p>	<p>THIS DRAWING IS A CONTROLLED DOCUMENT FOR AMP INCORPORATED. IT IS SUBJECT TO CHANGE AND THE CONTROLLING ENGINEERING ORGANIZATION SHOULD BE CONTACTED FOR THE LATEST REVISION.</p>	<p>EDP TIN PLATED</p>	<p>AMP</p>	<p>SCALE NTS</p>	<p>SHEET 1 OF 1</p>			